

The Courses and distances up the

River are as follows

- N. 71 W. 33
  - N. 51 W. 66
  - N. 2 W. 120
  - North 28
  - N. 20 W. 43
  - N. 31 W. 34
  - N. 45 W. 22
  - N. 62 W. 30
  - N. 83 W. 30
  - S. 55 W. 20
  - S. 23 W. 18
  - S. 13 W. 32
  - South 95 1/2
  - S. 28 W. 12
  - S. 62 W. 64
  - S. 53 W. 22
  - S. 76 W. 46
  - S. 50 W. 28
  - S. 22 W. 17
  - S. 16 E. 12
  - S. 54 E. 22
  - S. 80 E. 28
  - N. 86 E. 60
  - S. 81 E. 31
  - S. 52 E. 51
  - S. 3 E. 30
- 1046 1/2

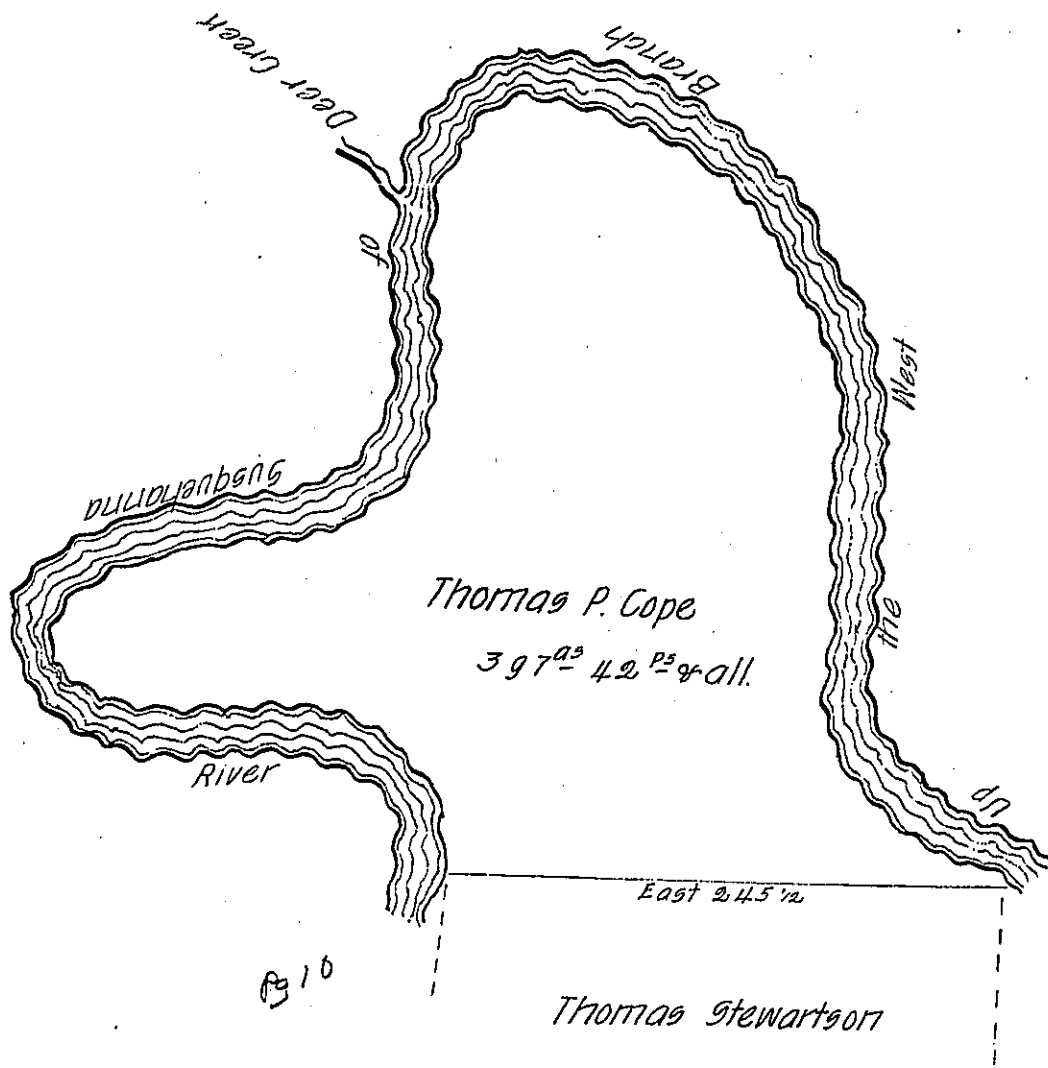

Situate on the south side of the West Branch of Susquehanna River in a large bend opposit the Mouth of Deer Creek in Huntingdon County Allegheny Township containing three hundred and ninety seven Acres forty two Perches and the Usual Allowance for Roads surveyed the 20<sup>th</sup> Day of April 1797 for Thomas P. Cope in pursuance of a Warrant dated the 15<sup>th</sup> Day of March 1797.

John Canan D.G.

Daniel Brodhead Esq<sup>r</sup> S.G.

IN TESTIMONY that the above is a copy of the original remaining on file in the Department of Internal Affairs of Pennsylvania, made conformably to an Act of Assembly approved the 16th day of February, 1833, I have hereunto set my Hand and caused the Seal of said Department to be affixed at Harrisburg, this sixth day of June 1904

*Grace R. Brown*  
Secretary of Internal Affairs.